

CITY OF LOS ANGELES  
DEPARTMENT OF BUILDING AND SAFETY  
ZONING INFORMATION FILE  
Effective Date: October 21, 2001

**ZI NO. 2295**  
**THE LOS ANGELES SPORTS AND ENTERTAINMENT DISTRICT SPECIFIC PLAN**

**COUNCIL DISTRICT: 9**

**COMMENTS:**

On October 21, 2001, Ordinance No. 174,224 became effective to establish the Los Angeles Sports and Entertainment District Specific Plan.

**INSTRUCTIONS:**

Issue no grading, foundation, building, sign or use of land permits for any Project on any lot located in whole or in part within the Specific Plan area unless the Director of Planning has issued a Project Permit Compliance Review except for interior alterations to an existing building or structure or demolition of one or more residential units. In issuing a Project Permit Compliance, the Director's review shall determine whether an individual Project is in compliance with those regulations, guidelines and mitigation measures which are set forth in the Los Angeles Sports and Entertainment District Specific Plan.

Refer all applicants who require a Planning clearance to the City Planning Department Community Planning Bureau staff person assigned to the Los Angeles Sports and Entertainment Specific Plan.

**Note:** Advise applicants that not all projects can be cleared the same day and that an appointment may be necessary.

All application for signs within 600 feet of the main traveled roadway of a freeway or for signs located at an elevation of 35 feet or less from grade shall also be referred to the Department of Transportation for a Hazard Determination.

If you have any questions regarding this matter, please contact the staff person assigned to the Los Angeles Sports and Entertainment Specific Plan, whose contact information can be found at <http://planning.lacity.org/phonelist/AssignmentList.pdf>.

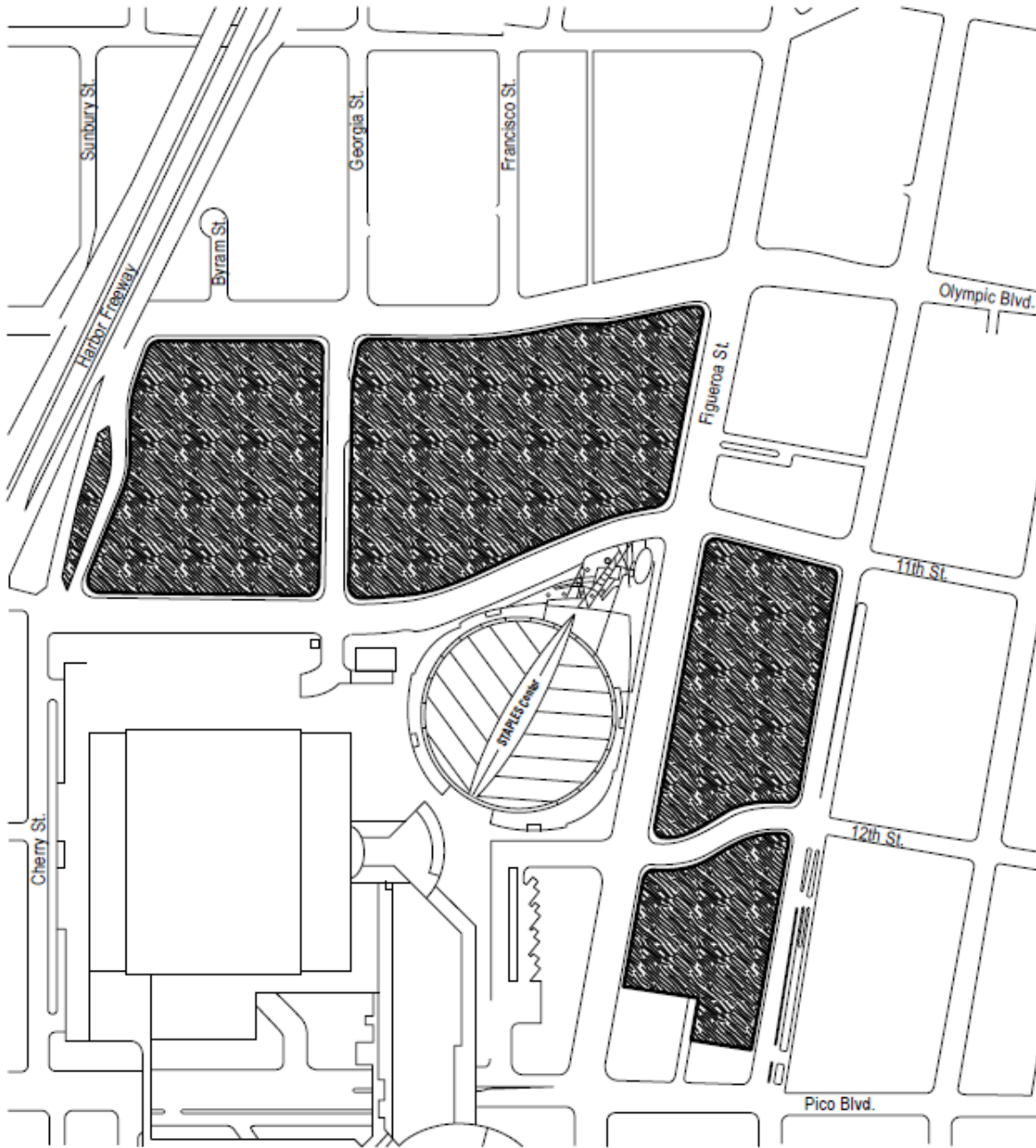

## LOS ANGELES SPORTS AND ENTERTAINMENT DISTRICT (LASED) SPECIFIC PLAN

Effective Date: October 13, 2001  
Ordinance No. 174225  
ZI 2295

Prepared by City of Los Angeles Planning Department • Graphics Section • May, 2003